

RECEIVED  
SEP 29 2017  
COMMUNITY DEVELOPMENT

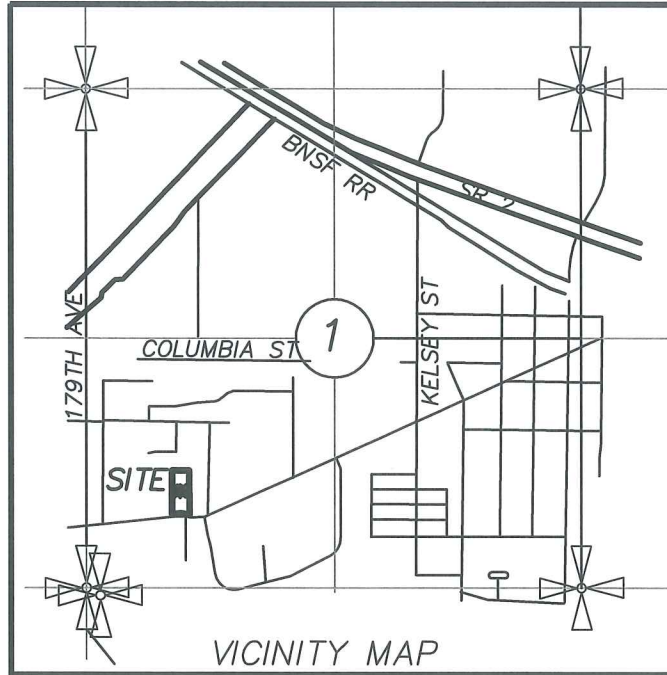

SCALE: 1' = 2000'

**VICINITY MAP for  
MAIN BROOK TOWNHOMES**

IN THE SW 1/4 OF THE SW 1/4 OF SECTION 1, T.27N., R.6E., W.M.  
CITY OF MONROE, SNOHOMISH COUNTY, WASHINGTON

**ORCA Land Surveying**  
3605 COLBY AVENUE, EVERETT, WA 98201  
425-259-3400 FAX: 425-258-1616

The logo for ORCA Land Surveying features a stylized mountain range on the left and a whale on the right, with a circular emblem containing a crosshair below the whale.

JOB NO. 2017-028  
DATE: 9/29/2017  
DWG BY: JLH